



**FortiMail™**  
Comprehensive Email Security



# FortiMail

FortiMail 60D, 200D, 200E, 400C, 400E, 1000D, 3000D and VM

## Comprehensive Email Security

### Proven Security

FortiMail appliances and virtual appliances are proven, powerful email security platforms for any size organization — from small businesses to carriers, service providers, and large enterprises. Purpose-built for the most demanding messaging systems, FortiMail appliances employ Fortinet’s years of experience in protecting networks against spam, malware, and other message-borne threats.

### Intelligent Protection

FortiMail prevents your email systems from becoming threat delivery systems. Its inbound filtering engine blocks spam and malware before it can clog your network and affect users. Its outbound inspection technology prevents other antispam gateways from blacklisting your users by blocking outbound spam and malware, including mobile traffic.

### Key Features & Benefits

<b>Flexible Deployment Options</b>	FortiMail can be deployed in gateway, transparent mode and as a fully featured mail server. With hardware, VM and cloud form factors, FortiMail is flexible enough to cater to every customer requirement.
<b>Apply Data Loss Prevention and Identity-Based Encryption</b>	Detect sensitive information using defined data patterns and ensure secure delivery with no additional hardware or software to install, no user provisioning, no recipient pre-enrollment.
<b>Prevent Phishing and Other Advanced Threats</b>	Apply embedded URL inspection, top rated antimalware and optional sandbox integration to detect highly targeted attacks.
<b>Identify and Block Spamming Endpoints</b>	Carriers and Service Providers, prevent blacklisting of legitimate subscribers by identifying and blocking endpoints sending spam.
<b>No Per-User or Per-Mailbox Pricing</b>	Complete, multi-layered antivirus, antispam, antispyware and antiphishing protection for an unlimited number of users. Greatly reduces TCO.

## Comprehensive Email Security

- Scalable solution from SME to the largest ISP and carrier networks
- Advanced Threat Outbreak Protection methods to protect against new emerging and targeted attacks
- Apply Identity-Based Encryption in both push and pull methods
- Data Leak Prevention, and Policy-Based Encryption and Archiving enable compliance with SOX, GLBA, HIPAA, PCI DSS
- Enforce email and security policies at a granular level
- Receive real-time security updates from FortiGuard® Services
- Industry leading price/performance
- Flexible deployment modes and architectures support the widest range of organizations
- Multi-layer threat detection delivers highest level of user protection
- Scalable solution delivers long term investment protection



Enforce secure content delivery with FortiMail Identity-Based Encryption (IBE), S/MIME, or TLS email encryption options. Prevent accidental and intentional loss of confidential data using predefined HIPAA, GLBA, SOX or customized dictionaries.

## High Performance and Unmatched Flexibility

FortiMail appliances provide high-performance email routing and security by utilizing multiple high-accuracy antispam filters. When coupled with industry leading real-time antivirus and antispymware protection from FortiGuard Services, FortiMail provides you with extremely fast and accurate email security that won't affect end users or delay their communications. FortiMail can be deployed in the cloud or on premises and gateway, inline and server modes in a range of appliance or virtual machine form factors. This flexibility allows you to deploy FortiMail in the mode that best suits your environment.

## Advanced Threat Protection

In addition to FortiGuard antivirus, FortiMail supports on-board code emulation to identify and block suspicious files based on their intended behavior. Optional cloud-based or on-premise "sandboxing" provide a full, contained, run-time environment to thwart the highly targeted and tailored attacks that increasingly bypass traditional defenses. Rich threat intelligence, actionable insight and the option to share information with FortiGuard Labs in order to receive automated protection updates help organizations reduce the risk of compromise and breach from such sophisticated attacks.

## FEATURES

### System

- Wide range of deployment options:
  - Transparent, Gateway and Server Mode
  - On-prem or public or private cloud deployment
- Inbound and Outbound Inspection
- Multiple Email Domains with Domain Level Customization
- IPv6 and IPv4 Address Support
- Virtual Hosting using Source and/or Destination IP Address Pools
- SMTP Authentication Support via LDAP, RADIUS, POP3 and IMAP
- LDAP-Based Email Routing
- Per User Inspection using LDAP Attributes on a Per Policy (Domain) Basis
- Comprehensive Webmail Interface for Server Mode Deployments and Quarantine Management
- Mail Queue Management
- Multiple Language Support for Webmail and Admin Interface
- Email RFC Compliance

### Management, Logging, and Reporting

- Basic/advanced management modes
- Per domain, role-based administration accounts
- Comprehensive activity, configurations change and incident logging and reporting
- Built-in reporting module
- Centralized quarantine for large scale deployments
- Optional centralized logging and reporting with FortiAnalyzer
- SNMP support using standard and private MIB with threshold-based traps
- Local or external storage server support, including iSCSI devices
- External Syslog support

### Antispam

- FortiGuard antispam service
  - Global sender reputation
  - Spam object checksums
  - Dynamic Heuristic Rules
- Real-time spam outbreak protection
- Spam and phishing URIs and email addresses
- Full category FortiGuard URL Filtering
- Greylisting for IPv4, IPv6 addresses and email accounts
- Local sender reputation (IPv4, IPv6 and End Point ID-based)
- Behavioral analysis
- Deep email header inspection
- Integration with third-party spam URI and real-time blacklists (SURBL/RBL)
- Newsletter detection
- PDF Scanning and image analysis
- Block/safe lists at global, domain, and user levels
- Support for enterprise sender identity standards:
  - Sender Policy Framework (SPF)
  - Domain Keys Identified Mail (DKIM)
  - Domain-Based Message Authentication (DMARC)
- Flexible action and notification profiles
- System and user self-service quarantine

## FEATURES

### High Availability (HA)

- High availability supported in all deployment scenarios
  - Active-Passive mode
  - Active-Active configuration synchronization mode
- Quarantine and mail queue synchronization
- Device failure detection and notification
- Link status, failover and redundant interface support

### Antimalware

- FortiGuard Antivirus detection
- Heuristic-based behavioral detection
- Real-time malware outbreak detection
- Cloud and On-prem sandbox integration

### Advanced

- Server mode deployment with advanced groupware functions
- Policy-based e-mail archiving with remote storage options
  - Support for Exchange journal archiving
- Comprehensive data-loss prevention with file fingerprinting and sensitive data detection
- Identity-based encryption

## DEPLOYMENT

Choose from three modes of deployment — Transparent, Gateway, or Server mode — to meet your specific email security requirements, while minimizing infrastructure changes and service disruptions:

**Gateway Mode:** Provides inbound and outbound proxy mail transfer agent (MTA) services for existing email gateways. A simple DNS MX record change redirects email to FortiMail for antispam and antivirus scanning. The FortiMail device receives messages, scans for viruses and spam, then relays email to its destination email server for delivery.

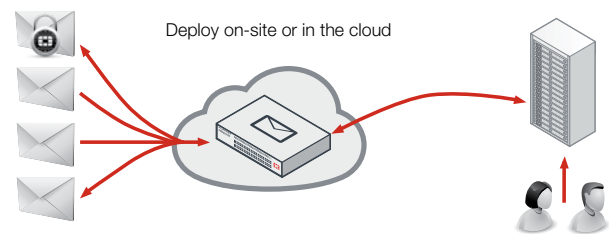

**Transparent Mode:** Each network interface includes a proxy that receives and relays email. Each proxy can intercept SMTP sessions even though the destination IP address is not the FortiMail appliance. FortiMail scans for viruses and spam, then transmits email to the destination email server for delivery. This eliminates the need to change the DNS MX record, or to change the existing email server network configuration.

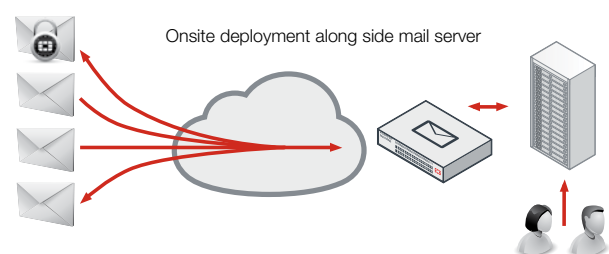

**Server Mode:** The FortiMail device acts as a stand-alone messaging server with full SMTP email server functionality, including flexible support for secure POP3, IMAP and WebMail access. FortiMail scans email for viruses and spam before delivery. As in Server mode, external MTAs connect to FortiMail, allowing it to function as a protected server.

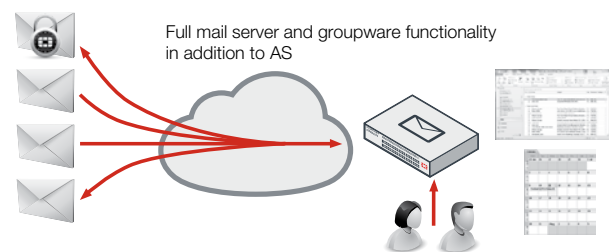

## DEPLOYMENT

### Identity-Based Encryption (IBE)

IBE allows FortiMail to deliver confidential and regulated email securely — without requiring additional hardware, software user provisioning, or extra license fees. Use IBE to eliminate paper-based communications and reduce costs.

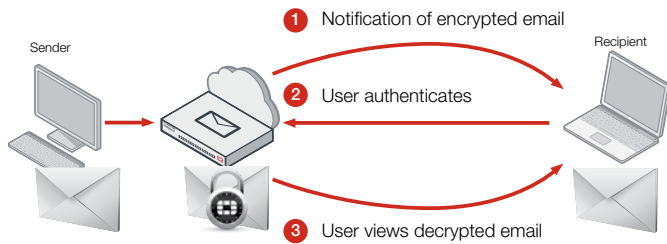

**Policy-Based Encryption:** Automatically encrypt messages for compliance, based on content or recipient.

**Push or Pull Mode:** Use Push, Pull, or a combination of modes to meet your requirements.

**Easy to Deploy, Use, and Manage:** Deploy IBE in any mode, including Transparent mode, without user provisioning or additional hardware or software.

## SPECIFICATIONS

	FORTIMAIL 60D	FORTIMAIL 200D	FORTIMAIL 200E	FORTIMAIL 400C
<b>Recommended Deployment Scenarios</b>	Demo, testing, training and small enterprise use with fewer than 100 users*	Small businesses, branch offices, and organizations with fewer than 400 users*		Small-to-midsized organizations with up to 1000 users*
<b>Hardware Specifications</b>				
10/100/1000 Interfaces (Copper, RJ-45)	4	4	4	4
SFP Gigabit Ethernet Interface	0	0	0	0
Storage	1x 500 GB	1x 1 TB	1 x 1TB	2x 1 TB
RAID Storage Management	No	No	No	Software: 0, 1
Form Factor	Desktop	1U	1U	1U
Power Supply	External	Single	Single	Single
<b>System Specifications</b>				
Configured Domains **	2	20	20	100
Recipient-based Policies (per Domain / per System) — Incoming or Outgoing	15 / 30	60 / 300	60 / 300	600 / 3000
Server Mode Mailboxes	50	150	150	400
Antispam, Antivirus, Authentication, and Content Profiles (per Domain / per System)	10 / 15	50 / 60	50 / 60	50 / 200
<b>Performance (Messages/Hour) [Without queuing based on 100 KB message size]</b>				
Email Routing	3.6 K	76 K	80 K	150 K
FortiGuard Antispam	3.1 K	68 K	71 K	140 K
FortiGuard Antispam + Antivirus	2.7 K	58 K	61 K	120 K
<b>Dimensions</b>				
Height x Width x Length (inches)	1.61 x 8.27 x 5.24	1.75 x 17.05 x 13.86	1.73 x 17.24 x 16.38	1.70 x 17.10 x 14.30
Height x Width x Length (mm)	41 x 210 x 133	45 x 433 x 352	45 x 433 x 352	44 x 435 x 364
Weight	2.6 lbs (1.2 kg)	13.4 lbs (6.1 kg)	13.4 lbs (6.1 kg)	16.1 lbs (7.3 kg)
<b>Environment</b>				
Power Source	External Power Supply 19V DC 2.1A 40 W	100–240V AC, 50–60 Hz	100–240V AC, 50–60 Hz	100–240V AC, 50–60 Hz
Maximum Current	110V/1.2A, 220V/1.2A	115V/6A, 230V/3A	100V/4A, 240V/2A	4.00A/110V, 2.00A/220V
Maximum Power Required	22 W	72 W	71 W	120 W
Power Consumption (Average)	18 W	60 W	59 W	100 W
Heat Dissipation	78 BTU/h	205 BTU/h	280 BTU/h	411 BTU/h
Humidity	10–90% non-condensing	5–95% non-condensing	5–95% non-condensing	10–90% non-condensing
Operating Temperature	32–104°F (0–40°C)	32–104°F (0–40°C)	32–104°F (0–40°C)	32–104°F (0–40°C)
Storage Temperature	-13–158°F (-25–70°C)	-13–158°F (-25–70°C)	-13–158°F (-25–70°C)	-4–158°F (-20–70°C)
<b>Compliance</b>				
	FCC Part 15 Class B, C-Tick, VCCI, CE, UL/cUL, CB	FCC Part 15 Class A, C-Tick, VCCI, CE, UL/cUL, CB	FCC Part 15 Class A, C-Tick, VCCI, CE, UL/cUL, CB, BSMI	FCC Part 15 Class A, C-Tick, VCCI, CE, UL/cUL, CB
<b>Certification</b>				
	VBSspam and VB100 rated	VBSspam and VB100 rated, Common Criteria NDPP, FIPS 140-2 Certified	VBSspam and VB100 rated, Common Criteria NDPP, FIPS 140-2 Compliant	VBSspam and VB100 rated

\* Recommended sizing for Gateway and Transparent deployments. For Server Mode, see Server Mode Mailbox metric. If unsure, please validate the model selection by checking the peak mail flow rates and average message size detail with a FortiMail specialist.

\*\* Configured domains is the total number of email domains that can be configured on the appliance. Domain Associations can be used to enable additional domains which share configuration with the primary domain to which they are assigned.

## SPECIFICATIONS

	FORTIMAIL 400E	FORTIMAIL 1000D	FORTIMAIL 3000D
<b>Recommended Deployment Scenarios</b>	Small to mid-sized organizations with up to 1000 users*	Mid to large enterprise, education and government departments with up to 3000 users*	Highest performing appliance for the largest University, corporate, ISP and carrier customers
<b>Hardware Specifications</b>			
10/100/1000 Interfaces (Copper, RJ-45)	4	6	4
SFP Gigabit Ethernet Interface	0	2	2
Storage	2x 1 TB	2x 2 TB (2x 2 TB Optional)	2x 2 TB (6x 2 TB Optional)
RAID Storage Management	Software: 0, 1	Hardware: 1, 5, 10, 50, Hot Spare (Based on Drive Count)	Hardware: 1, 5, 10, 50, Hot Spare (Based on Drive Count)
Form Factor	1U	2U	2U
Power Supply	Single (Dual Optional)	Dual	Dual
<b>System Specification</b>			
Configured Domains **	100	800	2,000
Recipient-Based Policies (per Domain / per System) — Incoming or Outgoing	600 / 3,000	1,500 / 7,500	1,500 / 7,500
Server Mode Mailboxes	400	1,500	3,000
Antispam, Antivirus, Authentication, and Content Profiles (per Domain / per System)	50 / 200	50 / 600	50 / 600
<b>Performance (Messages/Hour) [Without queuing based on 100 KB message size]</b>			
Email Routing	157 K	680 K	1.5 Million
FortiGuard Antispam	147 K	620 K	1.4 Million
FortiGuard Antispam + Antivirus	126 K	500 K	1.3 Million
<b>Dimensions</b>			
Height x Width x Length (inches)	1.75 x 17.05 x 13.86	3.50 x 17.24 x 14.49	3.44 x 18.99 x 29.72
Height x Width x Length (mm)	45 x 433 x 352	88 x 438 x 368	87.3 x 482.4 x 755
Weight	13.4 lbs (6.1 kg)	27.6 lbs (12.52 kg)	71.5 lbs (32.5 kg)
<b>Environment</b>			
Power Source	100–240V AC, 50–60 Hz	100–240V AC, 50–60 Hz	100–240V AC, 50–60 Hz
Maximum Current	100V/5A, 240V/3A	3.50A / 110V, 1.75A / 220V	10.0A / 110V, 5.0A / 220V
Maximum Power Required	131 W	138 W	487 W
Power Consumption (Average)	103 W	115 W	299 W
Heat Dissipation	482 BTU/h	471 BTU/h	1694 BTU/h
Humidity	5–95% non-condensing	5–95% non-condensing	20–90% non-condensing
Operating Temperature	32–104°F (0–40°C)	32–104°F (0–40°C)	50–95°F (10–35°C)
Storage Temperature	-13–167°F (-25–75°C)	-13–158°F (-25–70°C)	-40–149°F (-40–65°C)
<b>Compliance</b>			
	FCC Part 15 Class A, C-Tick, VCCI, CE, UL/cUL, CB	FCC Part 15 Class A, C-Tick, VCCI, CE, UL/cUL, CB	FCC Part 15 Class A, C-Tick, VCCI, CE, BSMI, KC, UL/cUL, CB, GOST
<b>Certification</b>			
	VBSpam and VB100 rated, Common Criteria NDPP, FIPS 140-2 Compliant	VBSpam and VB100 rated, Common Criteria NDPP, FIPS 140-2 Compliant	VBSpam and VB100 rated, Common Criteria NDPP, FIPS 140-2 Certified

\* Recommended sizing for Gateway and Transparent deployments. For Server Mode, see Server Mode Mailbox metric. If unsure, please validate the model selection by checking the peak mail flow rates and average message size detail with a FortiMail specialist.

\*\* Configured domains is the total number of email domains that can be configured on the appliance. Domain Associations can be used to enable additional domains which share configuration with the primary domain to which they are assigned.



FortiMail 60D



FortiMail 200D



FortiMail 200E



FortiMail 400C

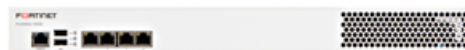

FortiMail 400E



FortiMail 1000D



FortiMail 3000D

## SPECIFICATIONS

Technical Specifications for FortiMail Virtual Appliances	VM00	VM01	VM02	VM04	VM08	VM16	VM32
<b>Recommended Deployment Scenarios</b>	Demo, testing, training and small enterprise use with fewer than 100 users*	Small businesses, branch offices, and organizations with fewer than 400 users*	Small to mid-sized organizations with up to 1000 users*	Mid to large enterprise with up to 3000 users*	Large enterprise	Large enterprise	Large enterprise
<b>Technical Specifications</b>							
Hypervisors Supported	VMware ESX/ESXi 4.0/4.1/5.0/5.1/5.5/6.0, Citrix XenServer 5.6 SP2/6.0 or later, Microsoft Hyper-V 2008 R2/2012/2012 R2, KVM (qemu 0.12.1), AWS (Amazon Web Services)						
Maximum Virtual CPUs Supported	1	1	2	4	8	16	32
Virtual NICs Required (Minimum/Maximum)	1 / 4	1 / 4	1 / 4	1 / 4	1 / 4	1 / 6	1 / 6
Virtual Machine Storage Required (Minimum/Maximum)	50 GB / 1 TB	50 GB / 1 TB	50 GB / 2 TB	50 GB / 4 TB	50 GB / 8 TB	50 GB / 12 TB	50 GB / 24 TB
Virtual Machine Memory Required (Minimum/Maximum)	1 GB / 2 GB	1 GB / 2 GB	1 GB / 4 GB	1 GB / 8 GB	1 GB / 16 GB	2 GB / 128 GB	2 GB / 128 GB
<b>Performance (Messages/Hour) [Without queuing based on 100 KB message size] **</b>							
Email Routing	3.6 K	34 K	67 K	306 K	675 K	875 K	1.2 M
FortiGuard Antispam	3.1 K	30 K	54 K	279 K	630 K	817 K	1.1 M
FortiGuard Antispam + Antivirus	2.7 K	26 K	52 K	225 K	585 K	758 K	1.0 M
<b>System Specifications</b>							
Configured Domains ***	2	20	100	800	2,000	2,000	2,000
Recipient-Based Policies (Domain / System) — Incoming or Outgoing	15 / 30	60 / 300	600 / 3,000	1,500 / 7,500	1,500 / 7,500	1,500 / 7,500	1,500 / 7,500
Server Mode Mailboxes	50	150	400	1,500	3,000	3,000	3,000
Antispam, Antivirus, Authentication, and Content Profiles (per Domain / per System)	10 / 15	50 / 60	50 / 200	50 / 600	50 / 600	50 / 600	50 / 600
* Recommended sizing for Gateway and Transparent deployments. For Server Mode, see Server Mode Mailbox metric. If unsure, please validate the model selection by checking the peak mail flow rates and average message size detail with a FortiMail specialist.							
** Hardware dependent. Indicative figures based on multiple VMs running on a shared system.							
*** Configured domains is the total number of email domains that can be configured on the appliance. Domain Associations can be used to enable additional domains which share configuration with the primary domain to which they are assigned.							

## ORDER INFORMATION

Product	SKU	Description
FortiMail 60D	FML-60D	Email Security Appliance — 4x GE RJ45 ports, 500 GB storage.
FortiMail 200D	FML-200D	Email Security Appliance — 4x GE RJ45 ports, 1 TB storage.
FortiMail 200E	FML-200E	Email Security Appliance — 4x GE RJ45 ports, 1 TB storage.
FortiMail 400C	FML-400C	Email Security Appliance — 4x GE RJ45 ports, 2 TB storage.
FortiMail 400E	FML-400E	Email Security Appliance — 4x GE RJ45 ports, 2 TB storage.
FortiMail 1000D	FML-1000D	Email Security Appliance — 2x GE SFP slots, 6x GE RJ45 ports, dual AC power supplies, 4 TB default storage.
FortiMail 3000D	FML-3000D	Email Security Appliance — 2x GE SFP slots, 4x GE RJ45 ports, dual AC power supplies, 4 TB default storage.
<b>Accessories</b>		
AC power supply for FML-400E	SP-FAD700-PS	Additional AC power supply for FML-400E.
HDD for FML-1000D	SP-D2000	2 TB 3.5" SATA hard drive with tray for FML-1000D.
HDD for FML-3000D	SP-D2TC	2 TB 3.5" SATA hard drive with tray for FML-3000D.
Rack mount tray for FML-60D	SP-RACKTRAY-01	Rack mount tray for FML-60D.



GLOBAL HEADQUARTERS  
Fortinet Inc.  
899 Kifer Road  
Sunnyvale, CA 94086  
United States  
Tel: +1.408.235.7700  
www.fortinet.com/sales

EMEA SALES OFFICE  
905 rue Albert Einstein  
Valbonne 06560  
Alpes-Maritimes, France  
Tel: +33.4.8987.0500

APAC SALES OFFICE  
300 Beach Road 20-01  
The Concourse  
Singapore 199555  
Tel: +65.6395.2788

LATIN AMERICA SALES OFFICE  
Sawgrass Lakes Center  
13450 W. Sunrise Blvd., Suite 430  
Sunrise, FL 33323  
United States  
Tel: +1.954.368.9990